

Rev.	ECN Number	Description	Date	Drawn	Checkd	Approved

技术要求:

1. 材质: 不锈钢 SUS301,  $T=0.15\pm0.005$ ;
2. 端子锡脚焊接面和接触面不可有毛边, 其他部位毛边最大 0.03mm;
3. 扭曲:  $45^\circ/1000\text{mm}$ , 拱形  $5\text{mm}/1000\text{mm}$ ;
4. 标示有“▼”符号的为重点控制和检验尺寸;
5. 未标注之 R MAX R0.13;
6. 电镀须满足 24 小时盐雾测试;
7. 寿命测试 > 2 万次, 产品弹力要求在 60gf~80gf 之间
8. 镍底 50~80u"min, 产品外表面镀锡 80~100U"MIN

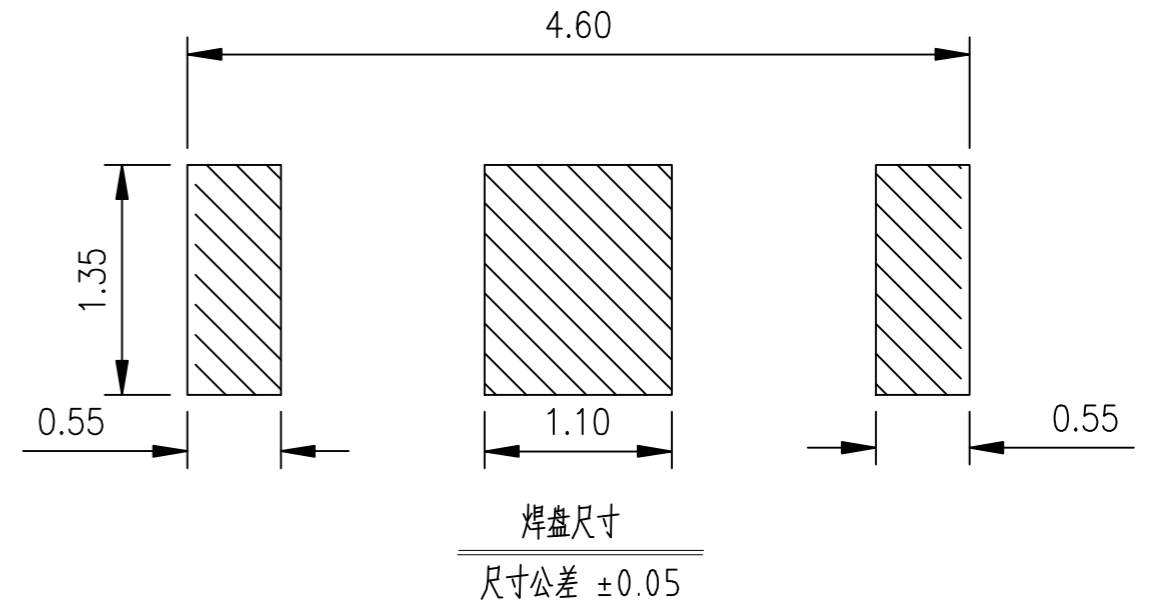
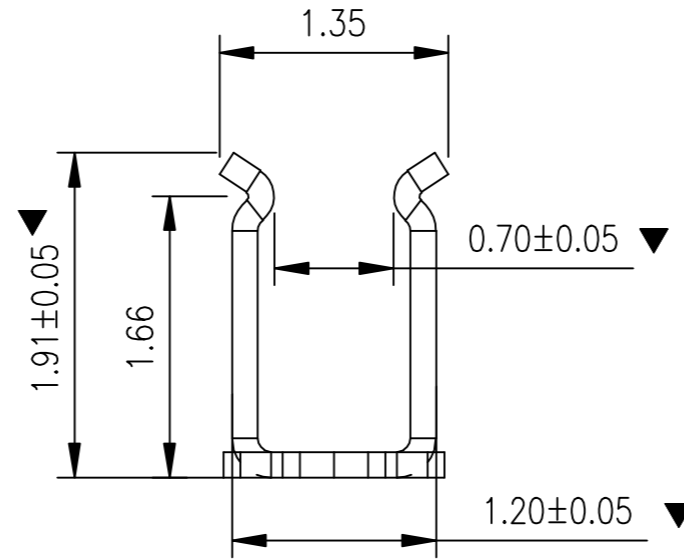
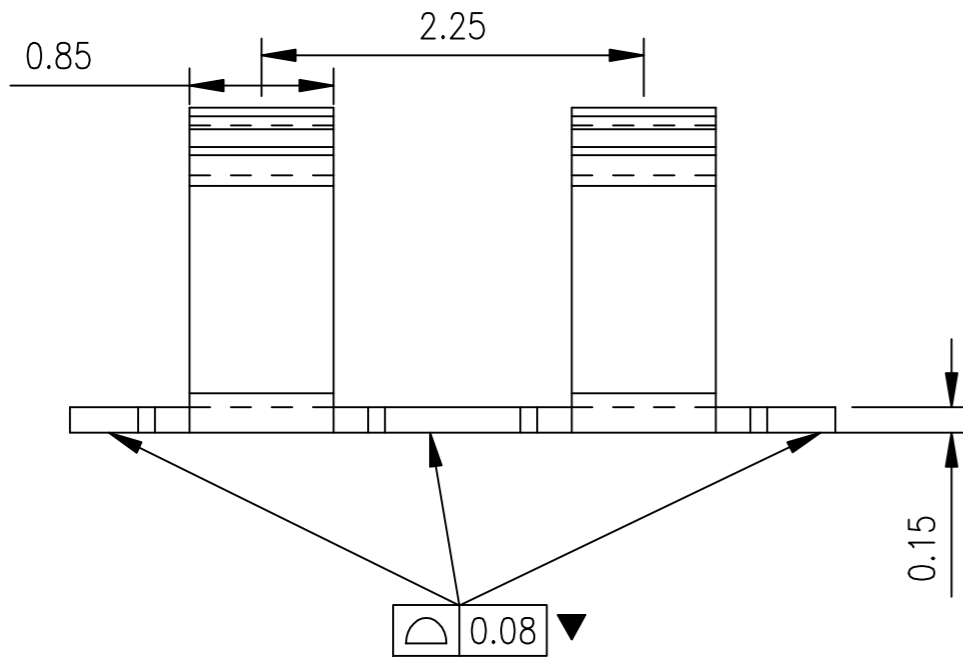
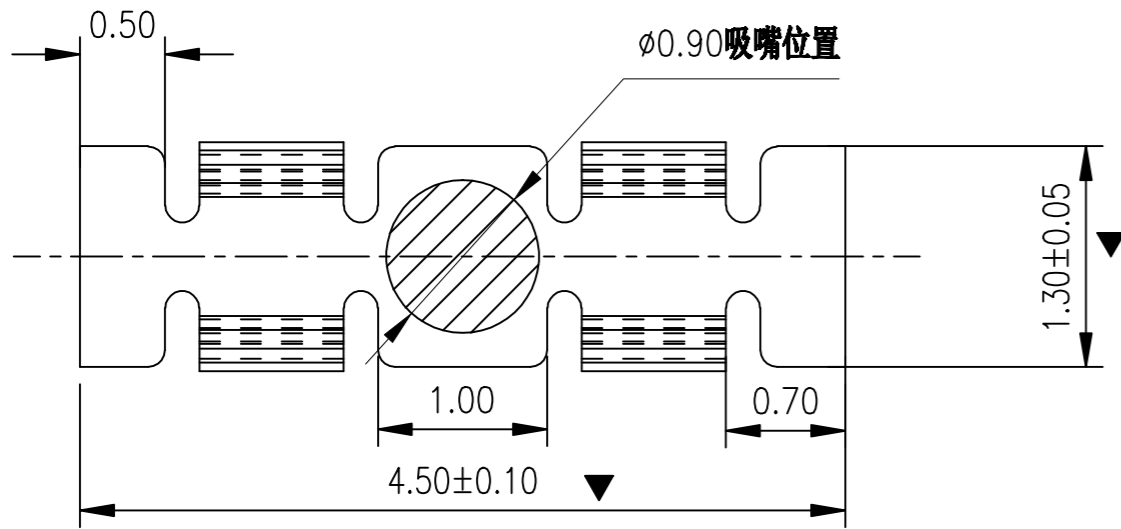

TITLE  
**客户图**  
 RF CABLE CAN CLIP  
 L4.5\*W1.30\*H1.90

GENERAL TOLERANCE	
XX. ±0.50	X.° ±2.0°
X. ±0.35	.X° ±1.0°
.X ±0.25	.XX° ±0.5°
.XX ±0.15	

SCALE: 1:1  
 UNIT: mm  
 SIZE: A4

DRAWN  
 CHECK  
 APPROVE

DATE  
 DATE  
 DATE

DWG. NO. 681-0077A-01  
 PARTS NO.(INTENDED USE) 0077A1  
 深圳市金航标电子有限公司  
 KH-PBJ-45135191  
 www.kinghelm.com.cn  
 0755-28190160

REV. A  
 SHEET 1/2